

STANZA

INS-VS1

ALL MEASUREMENTS ARE IN MILLIMETRES

MANUFACTURED FROM STAINLESS STEEL

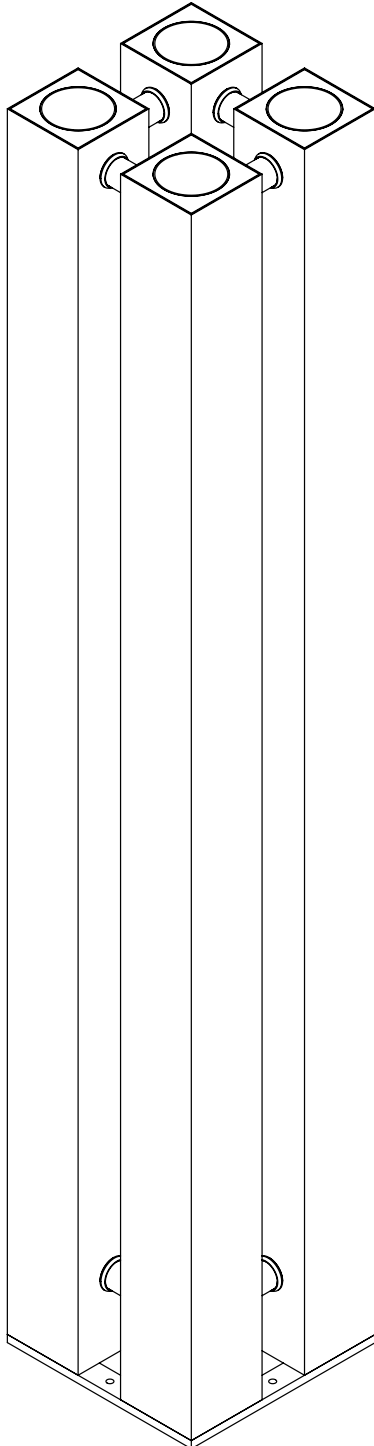

FLOOR MOUNT

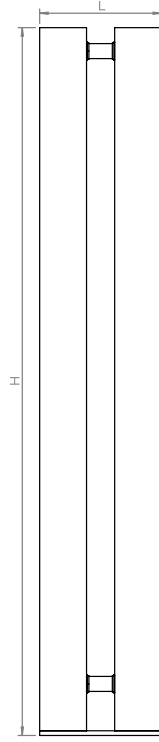

Front View

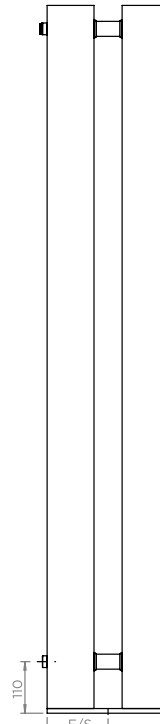

Side View

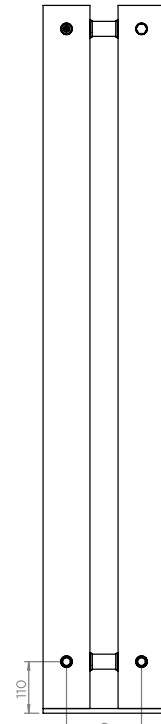

Back View

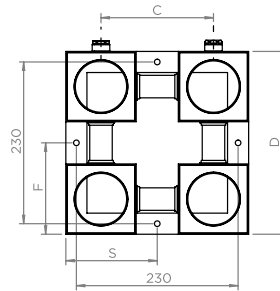

Top View

Plumbing Position:

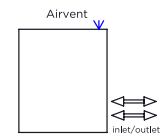

Installation Accessories:

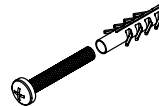

Vertical mount / Free S.
All Dimensions are in mm
Max. Working Pressure: 6 Bar
Max. Working Temperature: 95° C
Inlet / Outlet : 1/2" BSP
Fuel : E/H/D

Manufacturing Tolerance : - 5 mm

PRODUCT CODE	Height	Length	Depth	Pipe Centres	Bracket Centres	
	mm	mm	mm	mm	F	S
STA15	1510	260	260	160	130	130
STA18	1810	260	260	160	130	130
STA20	2010	260	260	160	130	130

Technical specifications are subject to change without prior notice.

AEON is the designer heating division of Pitacs Limited.
Pitacs Limited, Bradbourne Point, Bradbourne Drive, Tilbrook, Milton Keynes,
Buckinghamshire, MK7 8AT, UK

T: +44 (0)1908 271155 E: info@pitacs.com W: www.aeon.uk.com

