

# RENDE HORIZONTAL

INS-VS1

ALL MEASUREMENTS ARE IN MILLIMETRES

MANUFACTURED FROM STAINLESS STEEL

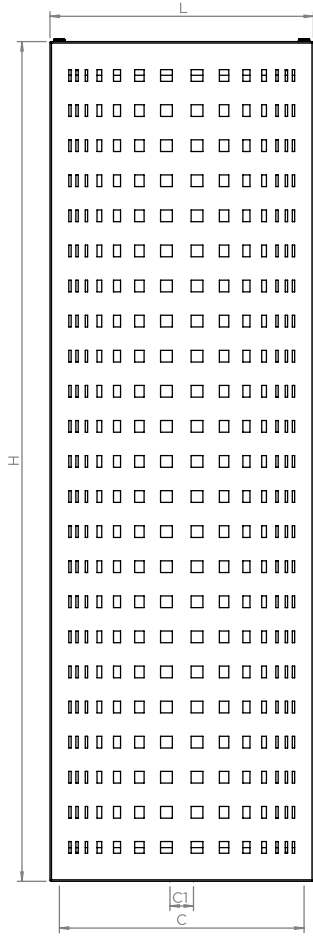
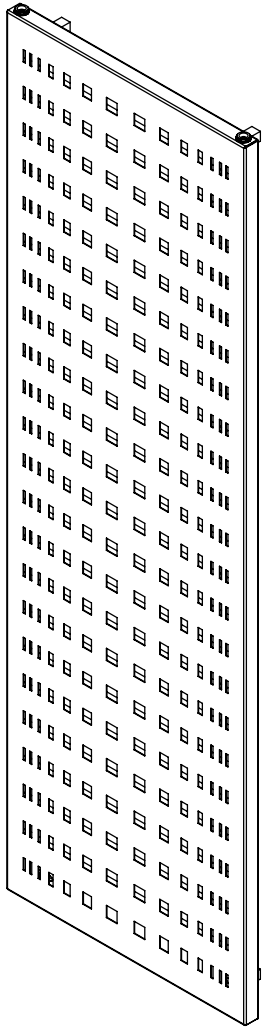

Front View

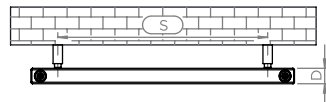

Top View

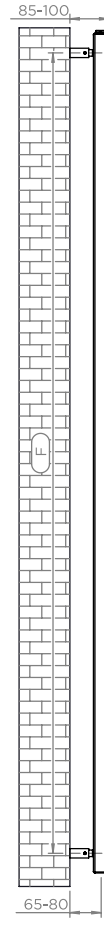

Side View

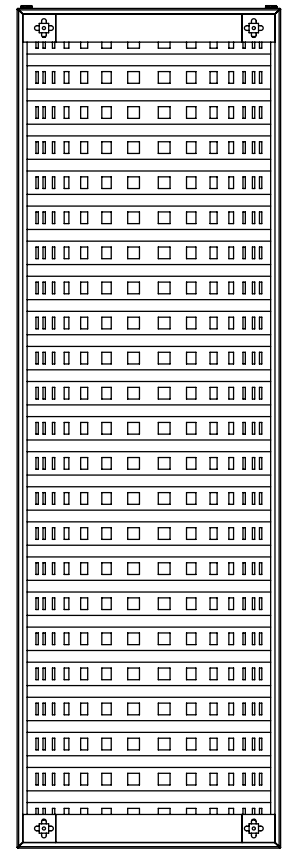

Back View

Installation Accessories:

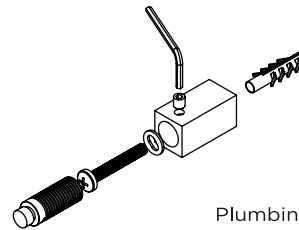
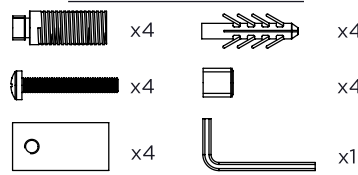

Plumbing Position:

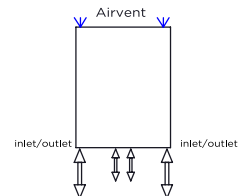

Vertical mount  
 All Dimensions are in mm  
 Max. Working Pressure: 10 Bar  
 Max. Working Temperature: 95° C  
 Inlet / Outlet : 1/2" BSP  
 Fuel : E/H/D

Manufacturing Tolerance : - 5 mm

PRODUCT CODE	Height	Length	Depth	Pipe Centres	Bracket Centres	
	H	L	D	C-C1	F	S
	mm	mm	mm	mm	mm	mm
RENH518	1800	560	33	520-50	445	1710
RENH520	2000	560	33	520-50	445	1910

FR,71-Rev,00

Technical specifications are subject to change without prior notice.



AEON is the designer heating division of Pitacs Limited.  
 Pitacs Limited, Bradbourne Point, Bradbourne Drive, Tilbrook, Milton Keynes,  
 Buckinghamshire, MK7 8AT, UK

T: +44 (0)1908 271155 E: info@pitacs.com W: www.aeon.uk.com