

KARE LT

INS-VS1

ALL MEASUREMENTS ARE IN MILLIMETRES

MANUFACTURED FROM STAINLESS STEEL

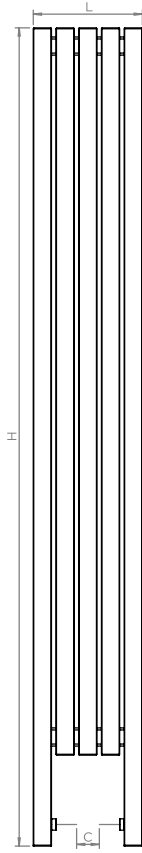
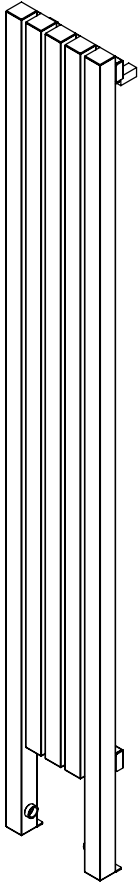

Front View

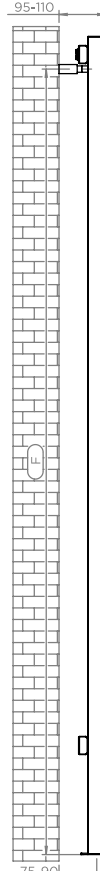

Side View

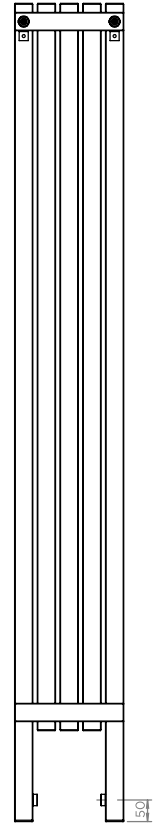

Back View

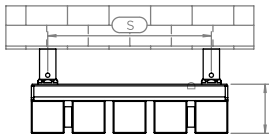

Top View

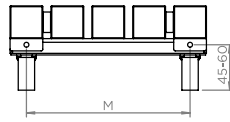

Bottom View

Installation Accessories:

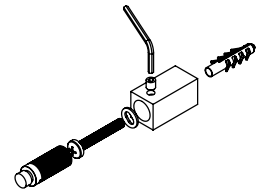
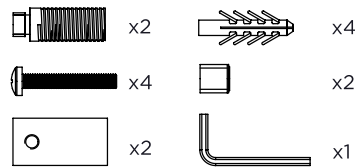

Plumbing Position:

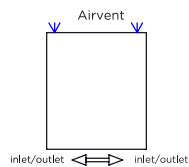

Vertical mount
 All Dimensions are in mm
 Max. Working Pressure: 10 Bar
 Max. Working Temperature: 95° C
 Inlet / Outlet : 1/2" BSP
 Fuel : E/H/D

Manufacturing Tolerance : - 5 mm

PRODUCT CODE	Height		Length		Depth		Pipe Centres			Bracket Centres		
	H	L	L	D	C	F	S	M	F	S	M	
KRLT7-15013	1500	340	60	150	1428	300	300					
KRLT5-18016	1800	240	60	50	1728	200	200					
KRLT6-18016	1800	290	60	100	1728	250	250					
KRLT5-20018	2000	340	60	150	1928	300	300					

FR.71-Rev.00

Technical specifications are subject to change without prior notice.

AEON is the designer heating division of Pitacs Limited.
 Pitacs Limited, Bradbourne Point, Bradbourne Drive, Tilbrook, Milton Keynes,
 Buckinghamshire, MK7 8AT, UK

T: +44 (0)1908 271155 E: info@pitacs.com W: www.aeon.uk.com

